



Introduction to Boxphish

 **BOXPHISH**

Who We Work With.

wakefieldcollege



Who We Work With.

MACMILLAN
CANCER SUPPORT



Housing 



Who We Work With.

MACMILLAN
CANCER SUPPORT



CLA

RENOLD



wilko

PRETTYLITTLETHING

WESLEYAN



ALLSAINTS

bruntwood ●



WHAT WE DO.



1. Identify your high-risk users via threat simulation
2. Train your staff to spot and avoid cyber attacks using 5-minute monthly training courses
3. Supply you with a monthly Human Risk Report to show performance and vulnerability within your ecosystem
4. Provide a very quick and cost-effective solution that can start bringing benefit in hours of deployment
5. Keep your people safe in both their personal and work life

Identify.



Your £10 Just Eat Voucher as a Key Worker



noreply@just-eat-voucher.co.uk <portal@boxphish.com>
to: Nick Deacon Elliot

ⓘ If there are problems with how this message is displayed, click here to view it in a web browser.

[Reply](#) [Reply All](#) [Forward](#)



A thank you from JUST EAT as a key worker - tuck in

WCG Employee, welcome to the tasty world of Just Eat - Claim your
voucher as a key worker!

Claim your £10.00 key worker voucher now

[Use now](#)

Account details

Username:

nde@boxphish.com

MacBook Pro

JUST EAT

For you Deliver with Just Eat Login Help



Download your £10.00 key worker
voucher now

Find restaurants delivering right now, near you

Enter your work email address

DOWNLOAD



MacBook Pro

A dark-colored laptop is shown from a front-facing perspective, slightly angled. The screen is white and displays a 404 error message. The word "oops!" is in a large, bold, dark gray font. Below it is a simple line-art sad face consisting of a downward-curving arc. Underneath the face, the text "404. That's an error." is written in a smaller, lighter gray font. The laptop's bezel is visible, and the "MacBook Pro" text is printed on the bottom edge of the screen frame.

oops!

404. That's an error.

MacBook Pro

Account Verification



noreply@linkedinverify.co.uk <info@noreply-linkedinverify.co.uk>

To: Nick Deacon Elliott



You forwarded this message on 30/11/2020 16:07.

If there are problems with how this message is displayed, click here to view it in a web browser.

[Reply](#) [Reply All](#) [Forward](#)



Nick Deacon Elliott,

We think that someone else might have accessed your LinkedIn account or you signed in from another computer or device recently.

When this happens, we require you to verify your identity with a security challenge. To prevent us from blocking your LinkedIn account, follow the link below to verify now.

[Verify Your LinkedIn Account](#)

Please note that this is just a precautionary measure, but if you are concerned that your account has been compromised, please visit our [customer support](#) page.

Thanks,
The LinkedIn Team

© 2018 LinkedIn Corporation

MacBook Pro

Microsoft Security Alert



Microsoft Security Alert <noreply@microsoft-notifications.co.uk>
To Nick Deacon Elliott



Thu 25/02/2021 08:43



Microsoft

Security alert

Dear Nick Deacon Elliott,

We believe a third party may have accessed your Microsoft account. When this happens, we require you to verify your identity with a security challenge and then change your password the next time you sign in.

If someone else has access to your account they might be trying to access your personal information or send junk mail.

Please use the button below and follow the steps to complete this as soon as possible to avoid Boxphish being subjected to cyber attacks.

[Recover account](#)

Learn how to [make your account more secure](#).

The Microsoft Team

MacBook Pro



MacBook Pro

OOPS, YOU'VE CLICKED SOMETHING YOU SHOULDN'T HAVE!

**This wasn't a real cyber attack,
but it could have been.**

The email you received was sent from Boxphish, but if it had been a real attack cyber criminals could already have access to your login credentials and other confidential personal or business data.

Learn from this experience.

Take a look at the hints and tips below, then please take the Phishing Awareness Training Course. You can do this by hitting the **TAKE COURSE** button at the bottom of this page.



Public Domains

Legitimate organisations
will never contact you



Domain Spoofing

Email addresses may appear
genuine at first glance but

From: One Drive Account Deletion <noreply@microsoft-notifications.co.uk>
Sent: 13 September 2021 17:33
To: Nick Deacon Elliott <nde@boxphish.com>
Subject: [onedrive@microsoft.com](https://onedrive.microsoft.com)



Your account will be deleted on 30/04/2021

Your account has been unused for the past two years,
and will be deleted on 30/04/21.

If you would like to keep your account, please visit OneDrive to reactivate it.

[Go to OneDrive](#)

The OneDrive Team

This email was sent from an unmonitored mailbox.

You are receiving this email because you have a Microsoft OneDrive account.
[Privacy Statement](#)

Microsoft Corporation, One Microsoft Way, Redmond, WA 98052 USA

MacBook Pro



noreply@google.com <noreply@gmaillogin.co.uk>

To Sam McDougall

1 If there are problems with how this message is displayed, click here to view it in a web browser.

Reply

Reply All

Forward

Print

More

Thu 10/02/2022 15:15



New device signed in to

sam.mcdougall@boxphish.com

Your Google Account was just signed in to from a new device.
You're getting this email to make sure it was you.

CHECK ACTIVITY

You received this email to let you know about important changes to your Google account and services.

© 2018 Google Inc, 1600 Amphitheatre Parkway, Mountain View, CA, 94043, USA

MacBook Pro

Educate.





We have partnered with Boxphish to launch a Cyber Security Awareness programme which will be starting soon.

Over the last 12 months, cyber crime and scamming is at an all time high. It is vital to the safety of both **you** and the **organisation** that we know how to spot such attacks.

Please make sure to keep an eye out and take the time to complete your assigned courses, coming soon.

Stay Safe. Stay Aware.

HOW TO SIGN IN USING MICROSOFT SINGLE SIGN-ON

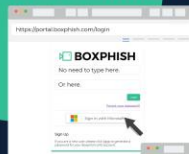

STEP ONE
Click the 'Sign in with Microsoft' button



STEP TWO
Sign in using your Microsoft account (if you aren't already)



STEP THREE
You're in!
Click the 'take now' to begin

Brought to you by
BOXPHISH

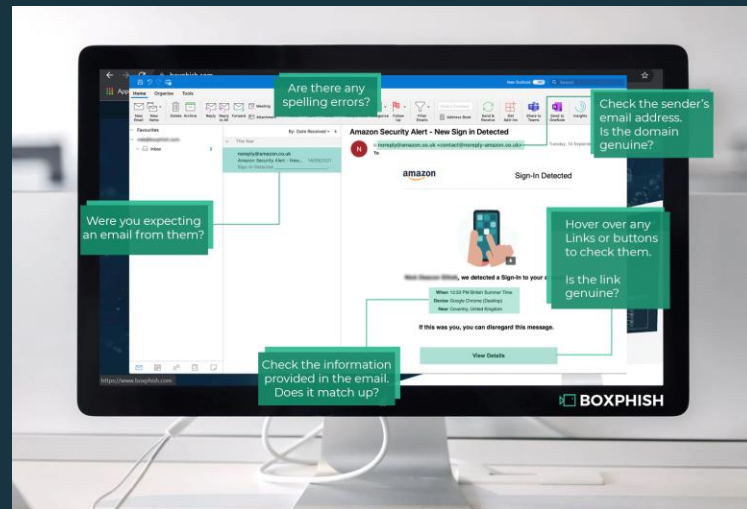

BOXPHISH



Accident waiting to happen?

An untidy desk could be a criminal's dream.

Secure all confidential data properly.

BOXPHISH



Tipping off the bad guys?

Hackers can use your social media profiles with password hints to access data.

Be careful what you post.

BOXPHISH



Downloading demons?

Viruses can be hidden inside files or programs that appear safe.

Check the download's source

BOXPHISH



Being tricked to click?

92% malware arrives via email*

*Verizon Data Breaches Investigations Report

Don't take the bait

BOXPHISH

www.dodgy.scammers.com

CLICK HERE

Get hover happy!

Holding your cursor over a link shows you where you'll really be sent.

Check before you click.

BOXPHISH



Suspicious sender?

Treat emails from companies you haven't heard of carefully.

Try googling the company to check it's genuine.



Login

[Forgot your password?](#)



Sign in with Microsoft

Sign Up

If you are a new user please click [here](#) to generate a password for your Boxphish LMS account.

Report.





THANKS!

hello@boxphish.com
www.Boxphish.com