

# AH40 1- to- 16 IP

Aperio® IP communication hub For use in indoor areas

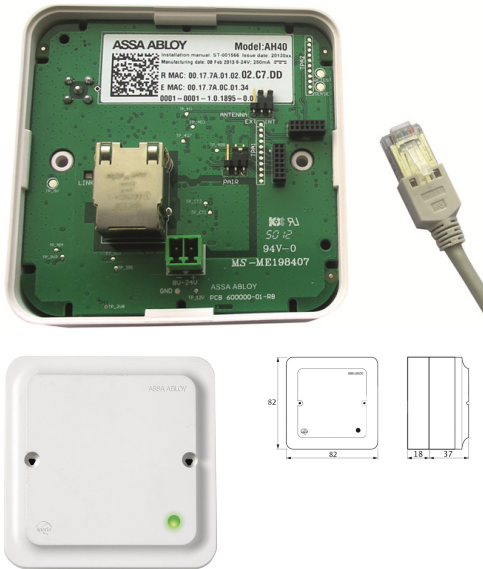







## Product description

- For connection to EAC system via IP/Ethernet connection
- Allows to connect up to 16 Aperio® devices on a single hub
- Integrated antenna with the option to mount an external antenna
- Encrypted radio communication
- TCP/IP communication encrypted using TLS 1.1/1.2
- Powered using Power over Ethernet (PoE) or external power supply
- For standard electrical installation boxes
- LED for status visualisation

## Scope of delivery

- 1 hub with installation instructions
- Wall-mounted housing
- Fixing screws

## Technical data - Aperio® IP communication hub

	<b>Approvals</b>	CB, CE, C-Tick, ETL, FCC, IC, ICASA
	<b>Safety and Emissions</b>	FCC 47CFR Part 15 subpart B and subpart C, IC RSS-210, EN ETSI 301 489-17 v2.2.1, EN ETSI 300 328 v1.8.1, EN 60950-1 2006 / A11:2009 / A12:2011 / A1:2010 / AC:2011, UL 294-2010
	<b>Dimension</b>	82 mm x 82 mm x 37 mm (H x W x D)
	<b>Required power supply</b>	PoE: IEEE 802.3af compliant class 1 Powered device (PD), External Power supply: The power supply shall be able to deliver minimum 3.5 W. The power supply shall be 3 A over current protected.
	<b>Radio standard</b>	IEEE 802.15.4 (2400 – 2483,5MHz), 16 channels (11-26)
	<b>Encryption (radio communication)</b>	AES 128 bits
	<b>Wireless operating range</b>	Typical range of 15-25 m depending on building environments
	<b>Receiver sensitivity</b>	-100 dBm
	<b>Wireless operating range</b>	10 dBm/MHz according to EN ETSI 300 328. Maximum spectral density
	<b>Internal antenna</b>	Two port cross polarized patch antenna
	<b>External antenna</b>	One reverse polarity SMA external antenna connector.
	<b>Class of protection</b>	IP 20
	<b>Operating temperature range</b>	5°C to 35°C
	<b>Relative humidity</b>	< 95% (non-condensing)
	<b>Status</b>	LED (red/green/orange)